



800-821-3177

AQUARIAN/ICE-AWAY PROPELLER REPLACEMENT INSTRUCTIONS

4/10/18

- STEP 1) Place the unit upright on a flat surface. **CAUTION: Do not allow the unit to fall over as damage may occur.**
- STEP 2) Remove the four 5/16-24 nylon-locking nuts and flat washers. Use a ½ inch wrench for the removal of the motor nuts.
- STEP 3) Lift the diffuser upward to clear the motor attachment studs. The propeller is not attached in anyway to the motor shaft other than the combination of a spline within the propeller and on the motor shaft and downward thrust. No screws, glues or fasteners are used.
- STEP 4) Grasp the propeller and pull upward close to the hub of the propeller. The hub of the propeller is “splined” to engage the splined shaft of the motor. The force to disengage the propeller from the motor shaft may require the use of a flat bladed screwdriver positioned with the flat of the blade just under the hub of the propeller. Using one of the motor studs as a fulcrum point, exert downward pressure on the handle of the screwdriver to assist in the removal of tightly fitting propellers.
- STEP 5) Remove the old rubber shaft slinger and washer from the motor shaft. Install new spline washer over motor shaft and install new rubber shaft slinger with large end down.
- STEP 6) Align the replacement propeller hub spline with the motor shaft spline and press downward. It may be necessary, due to tightly fitting propellers to “TAP” the propeller into the seated position on the motor shaft using the handle end of a hammer. **CAUTION: Do not use excessive force or hammering to the propeller on to the motor shaft. Damage will result to the propeller, motor OR both.**
- STEP 7) Reinstall the four flat washers and secure with the four nylon lock nuts. Tighten to 85-in/lbs. of torque.

SEE DRAWING ON THE REVERSE SIDE

PARTS LIST

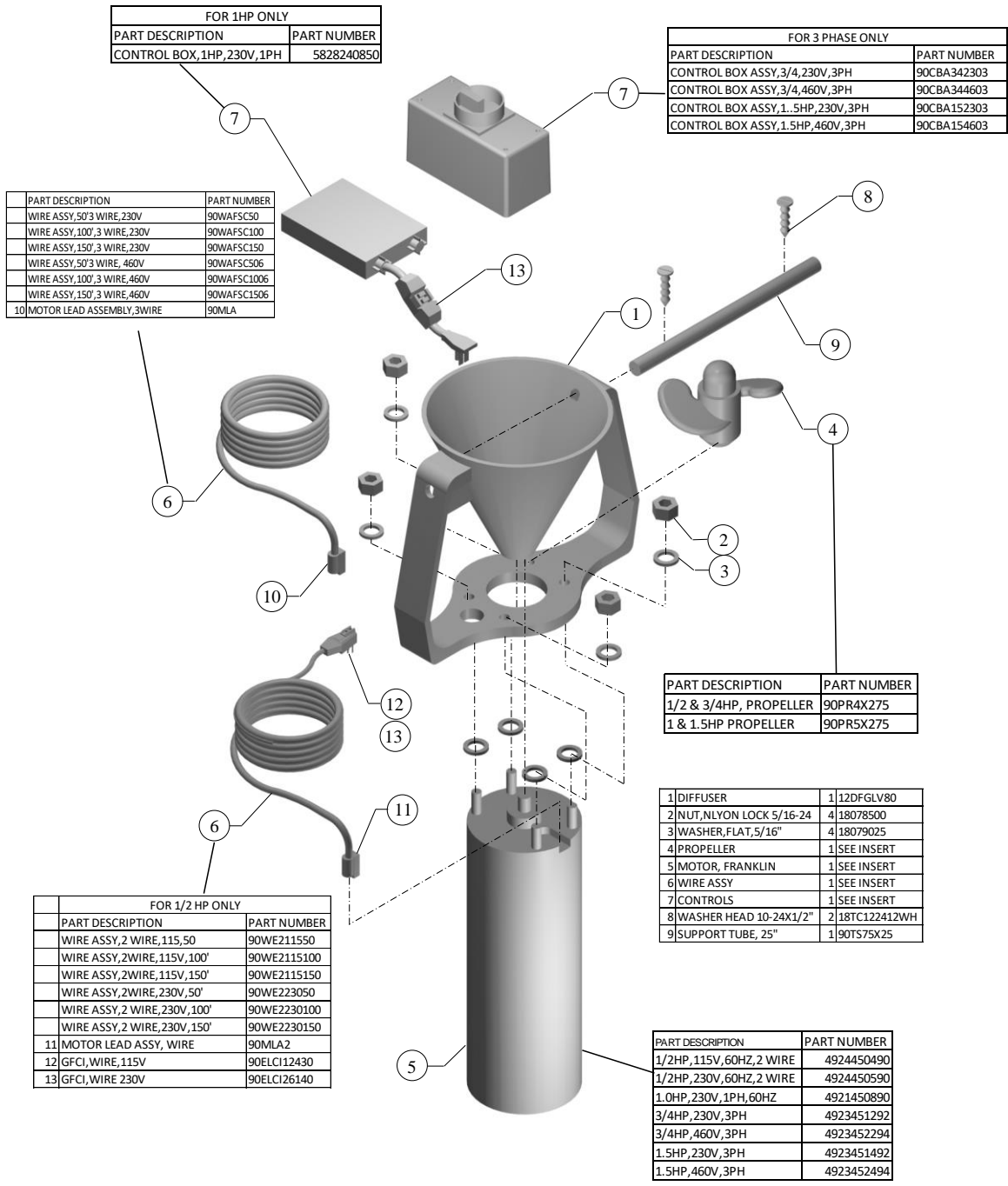

FOR 1HP ONLY	
PART DESCRIPTION	PART NUMBER
CONTROL BOX, 1HP, 230V, 1PH	5828240850

FOR 3 PHASE ONLY	
PART DESCRIPTION	PART NUMBER
CONTROL BOX ASSY, 3/4, 230V, 3PH	90CBA342303
CONTROL BOX ASSY, 3/4, 460V, 3PH	90CBA344603
CONTROL BOX ASSY, 1.5HP, 230V, 3PH	90CBA152303
CONTROL BOX ASSY, 1.5HP, 460V, 3PH	90CBA154603

PART DESCRIPTION	PART NUMBER
WIRE ASSY, 50' 3 WIRE, 230V	90WAFSC50
WIRE ASSY, 100' 3 WIRE, 230V	90WAFSC100
WIRE ASSY, 150' 3 WIRE, 230V	90WAFSC150
WIRE ASSY, 50' 3 WIRE, 460V	90WAFSC506
WIRE ASSY, 100' 3 WIRE, 460V	90WAFSC1006
WIRE ASSY, 150' 3 WIRE, 460V	90WAFSC1506
10 MOTOR LEAD ASSEMBLY, 3WIRE	90MLA

PART DESCRIPTION	PART NUMBER
1/2 & 3/4HP, PROPELLER	90PR4X275
1 & 1.5HP PROPELLER	90PR5X275

1 DIFFUSER	1 12DFGLV80
2 NUT, NYLON LOCK 5/16-24	4 18078500
3 WASHER, FLAT, 5/16"	4 18079025
4 PROPELLER	1 SEE INSERT
5 MOTOR, FRANKLIN	1 SEE INSERT
6 WIRE ASSY	1 SEE INSERT
7 CONTROLS	1 SEE INSERT
8 WASHER HEAD 10-24X1/2"	2 18TC122412WH
9 SUPPORT TUBE, 25"	1 90TS75X25

FOR 1/2 HP ONLY	
PART DESCRIPTION	PART NUMBER
WIRE ASSY, 2 WIRE, 115, 50'	90WE211550
WIRE ASSY, 2 WIRE, 115V, 100'	90WE2115100
WIRE ASSY, 2 WIRE, 115V, 150'	90WE2115150
WIRE ASSY, 2 WIRE, 230V, 50'	90WE223050
WIRE ASSY, 2 WIRE, 230V, 100'	90WE2230100
WIRE ASSY, 2 WIRE, 230V, 150'	90WE2230150
11 MOTOR LEAD ASSY, WIRE	90MLA2
12 GFCI, WIRE, 115V	90ELCI12430
13 GFCI, WIRE 230V	90ELCI26140

PART DESCRIPTION	PART NUMBER
1/2HP, 115V, 60HZ, 2 WIRE	4924450490
1/2HP, 230V, 60HZ, 2 WIRE	4924450590
1.0HP, 230V, 1PH, 60HZ	4921450890
3/4HP, 230V, 3PH	4923451292
3/4HP, 460V, 3PH	4923452294
1.5HP, 230V, 3PH	4923451492
1.5HP, 460V, 3PH	4923452494